

FITZROY PLACE

Newsletter 23 – November 2013

Introduction

REMAINING STEELWORK TO NASSAU STREET FAÇADE AND NO₁₀ MORTIMER STREET HAS BEEN REMOVED



Works Summary

Gate 1 on Mortimer Street and Gates 2 & 3 on Cleveland Street remain the primary points for site deliveries and collections. Works activities concentrate on making all buildings weather tight; cladding / glazing and roof membrane works predominate across the site.

Internally, partitioning works continue to make good progress to most residential areas with electrical and plumbing installation works also on-going across all buildings, residential and commercial.

Restoration works have started to the interior of the Chapel and continue to make good progress to the roof and the exterior.

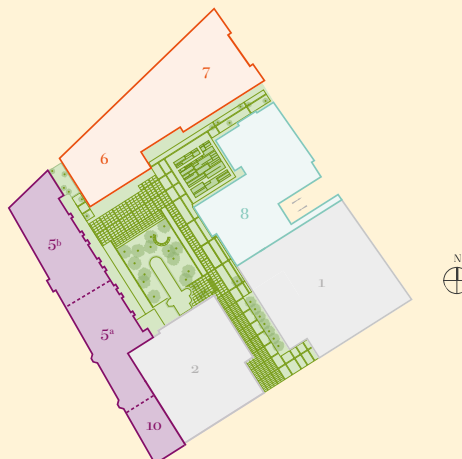

Sir Robert M'Alpine

Contact Information

Bruce Nixon

Community Liaison Manager

b.nixon@sir-robert-mcalpine.com

0800 0147593

Site Operating Hours

Mon – Fri: 8am – 6pm

Sat: 8am – 1pm



The coming months' activities

- Office Block 1: Roof finishes and plant being installed. Curtain walling being installed to Levels 6, 7 & 8. Windows complete to Level 5 and on-going Levels 6-8.
- Office Block 2: Roof arches and window installation continues.
- Block 5: Roof membrane complete. Mansard structure almost complete. Scaffold erection and façade renovation works continue. Courtyard windows complete.
- Block 6 & 7: Roof finishes and plant being installed, windows complete to Level 9, brickwork complete to Level 5.
- Block 8: Roof membrane installed. Window installation to East elevation almost complete.



Start of November.



End of November.

FITZROY PLACE

Traffic Routes

Cleveland Street and Nassau Street continue to be used for loading / off loading materials by crane.

The gates to the site entrance on Mortimer Street (Gate 1) are being used for access and egress of site traffic. Gate 4 on Cleveland Street is now in use and is the access and egress point for site skips.

Gates 2 & 3, also on Cleveland Street, are being used more frequently to ease pressure of traffic from Gate 1 on Mortimer Street.

We will continue to ensure we have the right number of marshals in place throughout the development.

Neighbourly Matters

We continue to work with neighbouring contractors, including those refurbishing the Cleveland Residences so that we can co-ordinate any works or activities that may have an adverse impact on the area.

There are no planned road closures this month.

2 of the 6 tower cranes have now been removed from site. We intend to remove one more of the cranes at the end of November, with a further crane planned to leave site in December. We now plan to remove the other two cranes in January 2014, separate information notices will follow for these events.

The site is registered with the Considerate Constructors Scheme (CCS), the national initiative set up by the construction industry to improve its image.

www.ccscheme.org.uk

The development team will aim to keep neighbours as informed as possible to any potential disturbance.

Fitzroy Place Community Web Site

This site now includes some time lapse films of the development's progress so far, as well as other content.

www.fitzroyplacecommunity.com

This is to help keep neighbours up to date with the development and contains useful information such as newsletters, contact details, answers to frequently asked questions and some progress photography.

Contact

Our Community Liaison Freephone Number is **0800 0147593**.

Should you prefer to receive this newsletter by email, please contact Bruce Nixon at b.nixon@sir-robert-mcalpine.com



Aerial view from Mortimer Street.



View from the junction of Riding House Street and Cleveland Street.



View from the junction of Mortimer Street and Cleveland Street.