

FITZROY PLACE

Newsletter 25 – February 2014

Introduction

FITZROY PLACE SURVIVES RECENT STORMS.



Works Summary

Despite the recent bad weather the project has not suffered unduly, the exception being the removal of the two remaining tower cranes that are in position on the two office blocks on Mortimer St have been delayed. With January now behind us, works activities continue to concentrate on making all buildings watertight; cladding / glazing and roof membrane works predominate across the site.

Internally, partitioning works are well underway to most residential areas with electrical and plumbing installation works also on-going across all buildings, residential and commercial.

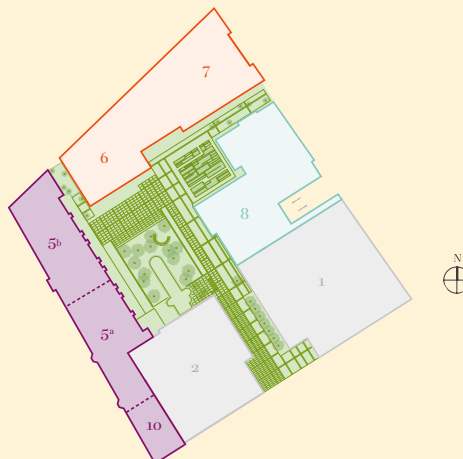

Sir Robert McAlpine

Contact Information

Bruce Nixon

Community Liaison Manager

b.nixon@sir-robert-mcalpine.com

0800 0147593

Site Operating Hours

Mon – Fri: 8am – 6pm

Sat: 8am – 1pm



The coming months' activities

- Remaining 2 tower cranes will be removed from site.
- Office Block 1 : Windows complete to Level 5 and curtain walling to 6-8 on-going.
- Office Block 2: Level 5 & 6 glazing in progress.
- Block 8 : Cladding & glazing to Level 9 & 10 in progress.
- Block 5: Scaffold wrap complete around to No 10 Mortimer St.
- Block 6 & 7 : Windows complete to Level 9, Brickwork to Level 4.
- Roof works and plant installation continues across all blocks.



Start of February.



End of February.

FITZROY PLACE

Traffic Routes

Cleveland St and Nassau St continue to be used for loading / off loading materials by crane.

The gates to the site entrance on Mortimer St (Gate1) are being used for access and egress of site traffic. Gate 4 on Cleveland St is now in use and is the access and egress point for site skips.

Gates 2 & 3, also on Cleveland St, are being used more frequently to ease pressure of traffic from Gate 1 on Mortimer Street.

We will continue to ensure we have the right number of marshals in place throughout the development.

Neighbourly Matters

We continue to work with neighbouring contractors, including those refurbishing the Cleveland Residences so that we can co-ordinate any works or activities that may have an adverse impact on the area.

Due to adverse weather condition the new schedule for the crane removal is as follows:

The schedule for the removal of the 2 remaining cranes is now:

- Tower crane 6 (far right hand side of the main gate on Mortimer Street) will be removed in stages starting on Friday 21st and will have left site by Sunday 23rd 18:00.
- Tower crane 7 (far left of the main gate on Mortimer Street) will be removed in stages starting on 28th February and will have left site by Sunday 2nd March 18:00

Again, these operations are weather dependent and separate information notices will follow should these events need to be rescheduled.

The development team will aim to keep neighbours as informed as possible to any potential disturbance.

The site is registered with the Considerate Constructors Scheme (CCS), the national initiative set up by the construction industry to improve its image.

www.ccscheme.org.uk

The development team will aim to keep neighbours as informed as possible to any potential disturbance.

Fitzroy Place Community Web Site

This site now includes some time lapse films of the development's progress so far, as well as other content.

www.fitzroyplacecommunity.com

This is to help keep neighbours up to date with the development and contains useful information such as newsletters, contact details, answers to frequently asked questions and some progress photography.

The development team will aim to keep neighbours as informed as possible to any potential disturbance.

Contact

Our Community Liaison Freephone Number is **0800 0147593**.

Should you prefer to receive this newsletter by email, please contact Bruce Nixon at b.nixon@sir-robert-mcalpine.com



View of the courtyard looking towards the BT tower.



View from the junction of Mortimer Street and Cleveland Street.

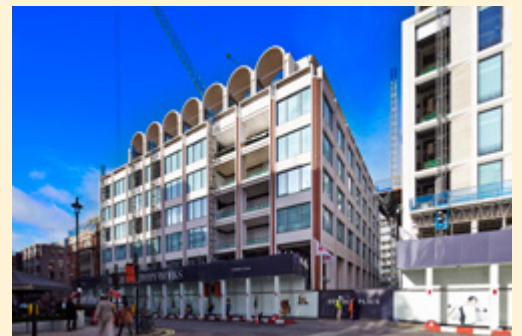

View from Berners Street.



View towards Mortimer St from Riding House St at high level.