

# FITZROY PLACE

Newsletter 27 – April 2014

## Introduction

# MORTIMER ST GANTRY BEING REMOVED



## Works Summary

All tower cranes have now been removed from site and the continuous suspension of the disabled parking bays in Nassau St has now finished. Windows to both Office Blocks are nearing completion.

The cladding and glazing is complete on residential Block 8. Works to the façade and windows continue on Block 5 with the Mansard structure being almost complete. Residential Blocks 6 & 7 have windows installed to Level 9, with brickwork, roof finishes and plant installation complete. The safety gantry has been removed from in front of Office Block 1 and we are now working on the removal of the gantry in front of Office Block 2.

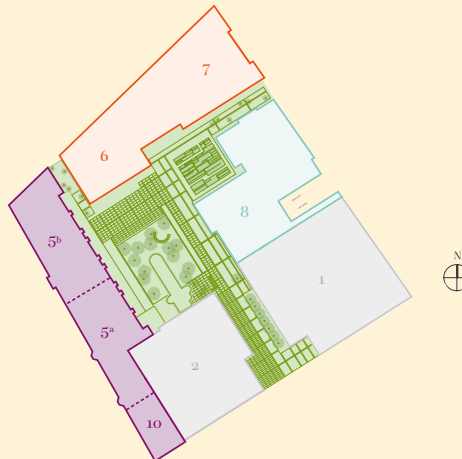

**Sir Robert McAlpine**

**Contact Information**

**Bruce Nixon**

Community Liaison Manager

b.nixon@sir-robert-mcalpine.com

0800 0147593

**Site Operating Hours**

**Mon – Fri:** 8am – 6pm

**Sat:** 8am – 1pm



## The coming months' activities

- Safety gantry removal will complete on Mortimer Street.
- Office Block 1: Curtain walling nearing completion.
- Office Block 2: Level 5 & 6 glazing in progress.
- Block 8: Cladding to the courtyard elevation nearing completion.
- Block 5: Scaffold wrap complete around to No 10 Mortimer St, work to façade and windows continues. Mansard structure almost complete.
- Block 6 & 7: Windows, Brickwork, roof finishes and plant installation completing.
- Roof works and plant installation approaching completion across all other blocks.



Start of April



End of April

# FITZROY PLACE

---

## Traffic Routes

The gates to the site entrance on Mortimer St (Gate1) are being used for access and egress of site traffic.

Gate 4 on Cleveland St is now in use and is the primary access and egress point for site skips.

Gates 2 & 3, also on Cleveland St, are being used more frequently to ease the pressure of traffic from Gate 1 on Mortimer Street.

We will continue to ensure we have the right number of traffic marshals in place throughout the development.

---

## Neighbourly Matters

We continue to work with neighbouring contractors, so that we can co-ordinate any works or activities that may have an adverse impact on the area.

Due to the works involved in removing the safety gantry on Mortimer Street, we have to close the footpath during the day; we will however reopen the footpaths during the evenings and weekends. We anticipate this aspect of the works complete this month.

The development team aim to keep neighbours as informed as possible to any potential disturbance.

The site is registered with the Considerate Constructors scheme, the Considerate Constructors Scheme (CCS) is the national initiative set up by the construction industry to improve its image.

<http://www.ccscheme.org.uk/>

---

## Fitzroy Place Community Web Site

This site now includes some time lapse films of the development's progress so far as well as other content.

[www.fitzroyplacecommunity.com](http://www.fitzroyplacecommunity.com)

This is to help keep neighbours up to date with the development and contains useful information such as newsletters, contact details, answers to frequently asked question and some progress photography.

The development team will aim to keep neighbours as informed as possible to any potential disturbance.

## Site Operating Hours

Mon – Fri 8.00 – 18.00  
Sat 8.00 – 13.00

---

## Contact

Our Community Liaison Free phone number is **0800 0147593**

Should you prefer to receive this newsletter by email, please contact Bruce Nixon at [b.nixon@sir-robert-mcalpine.com](mailto:b.nixon@sir-robert-mcalpine.com)



*View of the courtyard looking towards the BT tower.*



*View of Office Block 1 from Berners St.*



*View of Nassau St & Mortimer St.*



*View across the site looking south.*